

RKC/LED

Konfektionierbarer Steckverbinder, M12-Kupplung mit Schraubverschluss und LED-Betriebs- und Funktionsanzeige, Konfektionierung über Schraubklemmen (Leiterplatte inkl.)

Field attachable connector, M12 female connector with threaded joint and LED operation and function indicator, assembling with screw terminals (printed circuit board included)

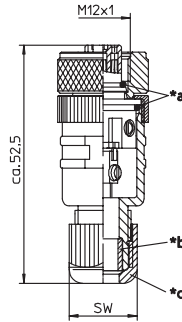

- *a O-Ring
O-ring
- *b Dichtung
gasket
- *c Hutmutter
cap nut

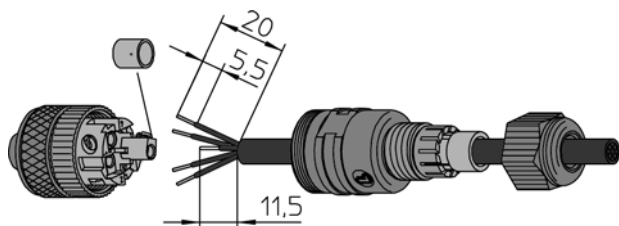

RKCW/LED

Konfektionierbarer Steckverbinder, M12-Winkelkupplung mit Schraubverschluss und LED-Betriebs- und Funktionsanzeige, Konfektionierung über Schraubklemmen (Leiterplatte inkl.)

Field attachable connector, M12 female right angle connector with threaded joint and LED operation and function indicator, assembling with screw terminals (printed circuit board included)

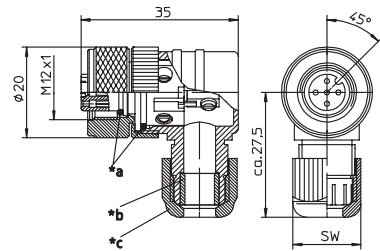

- *a O-Ring
O-ring
- *b Dichtung
gasket
- *c Hutmutter
cap nut

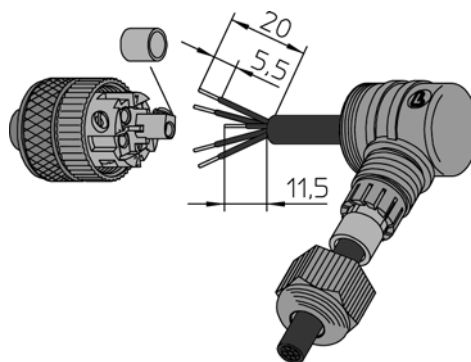

Pinbelegung Pin assignment

4-polig
4 poles





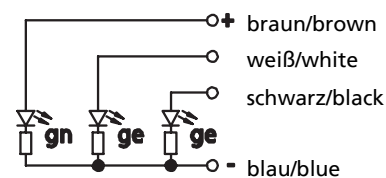

Schaltbild Wiring diagram



| | |
|--|---|
| Technische Daten | |
| Umgebungstemperatur | -25°C / +90°C |
| Werkstoffe | |
| Gehäuse / Griffkörper | PBT |
| Kontaktträger | PBT |
| Kontakt | CuZn, unterkupferte, CuSnZn |
| Gewindebuchse / Rändel- schraube/-mutter / Sechskant- schraube/-mutter / Hülse | CuZn, vernickelt |
| O-Ring | FKM |
| Mechanische Daten | |
| Schutzart | IP 67 Nur im verschraubten Zustand mit den dazugehörigen Gegen- stücken. |
| Anschlussart | Schraubanschluss |
| Anschließbarer Leiter | max. 0,75 mm ² |
| Elektrische Daten | |
| Durchgangswiderstand | ≤ 5 mΩ |
| Nennstrom bei 40°C | 4 A |
| Nennspannung | 10–30 V |
| Bemessungsspannung | 32 V |
| Isolationswiderstand | > 10 ⁹ Ω |
| Verschmutzungsgrad | 3 |

| | |
|---|---|
| Technical data | |
| Operating temperature range | -25°C / +90°C |
| Materials | |
| Housing / Molded body | PBT |
| Insert | PBT |
| Contact | CuZn, pre-coppered, CuSnZn |
| Receptacle shell / knurled screw/ nut / hexagon screw/nut / sleeve | CuZn, nickel-plated |
| O-ring | FKM |
| Mechanical data | |
| Degree of protection | IP 67 Only in locked position with its proper counterparts. |
| Mode of connection | screw terminals |
| Connectable conductor | max. 0.75 mm ² |
| Electrical data | |
| Contact resistance | ≤ 5 mΩ |
| Nominal current at 40°C | 4 A |
| Nominal voltage | 10–30 V |
| Rated voltage | 32 V |
| Insulation resistance | > 10 ⁹ Ω |
| Pollution degree | 3 |

| Bestellbezeichnung Designation | | Polzahl Poles | Kabelverschraubung Screw joint for cable | |
|-----------------------------------|--------------|------------------|---|---|
| RKC/LED 4/7 | RKCW/LED 4/7 | 4 | Ø 3,0–6,5 mm /SW 15 |   |
| RKC/LED 4/9 | RKCW/LED 4/9 | | Ø 4,0–8,0 mm /SW 19 |   |